

MYTC025 - Compact Actuator

The size 010 control loading actuator can be provided in an inline or L-shaped version to meet the space envelope needs as well as being located close to the controls.

This actuator has integrated modular control loading electronics and an output flange mounted torque sensor. The concept is based on the industrial motor and gearbox technology from Wittenstein and has been adapted for the simulation industry to provide the smoothest of feels. With the variety of gear ratios it is possible to provide a range of torques up to 750 Nm to meet the needs of the application.

This actuator can be used for pedal axes or as hydraulic replacement for example.

The specifications below are a selection of gear ratios. Other gear ratios are available and can be selected to match the application requirements.

The features of this actuator include:

- Low backlash, high torsional stiffness planetary gearbox
- 28 or 48 VDC Brushless motor
- High resolution encoder and integrated electronics

Ratio	<i>i</i>		31		40		61		91	
DC Bus Voltage	U_D	VDC	28	48	28	48	28	48	28	48
Maximum Torque	T_{Max}	Nm	171	176	221	227	337	346	503	516
Maximum Speed	$n@T_{Max}$	rpm	16	57	12	44	8	29	5	19
No load speed	n_o	rpm	34	88	26	69	17	45	12	30
Nominal Torque	T_n	Nm	95	92	122	119	187	182	279	271
Nominal Speed	n_n	rpm	19	63	14	49	9	32	6	22
Backlash	J_t	arcmin	<6							

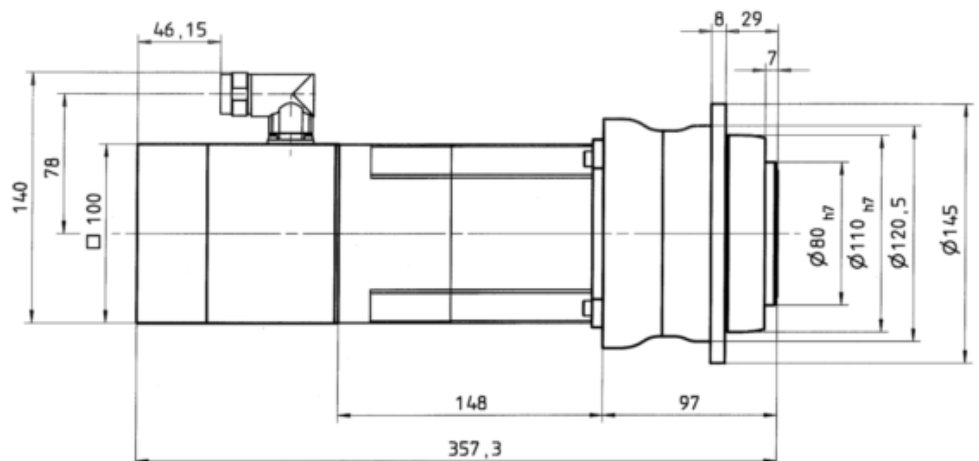
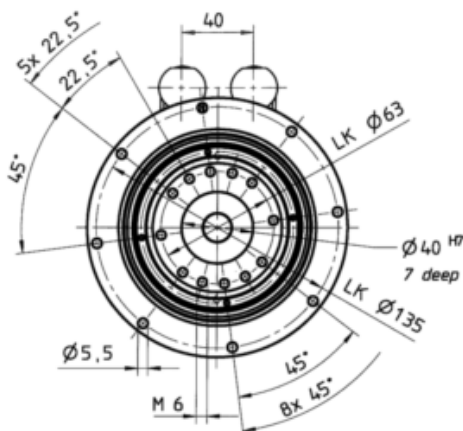

Wittenstein aerospace & simulation, Inc.